

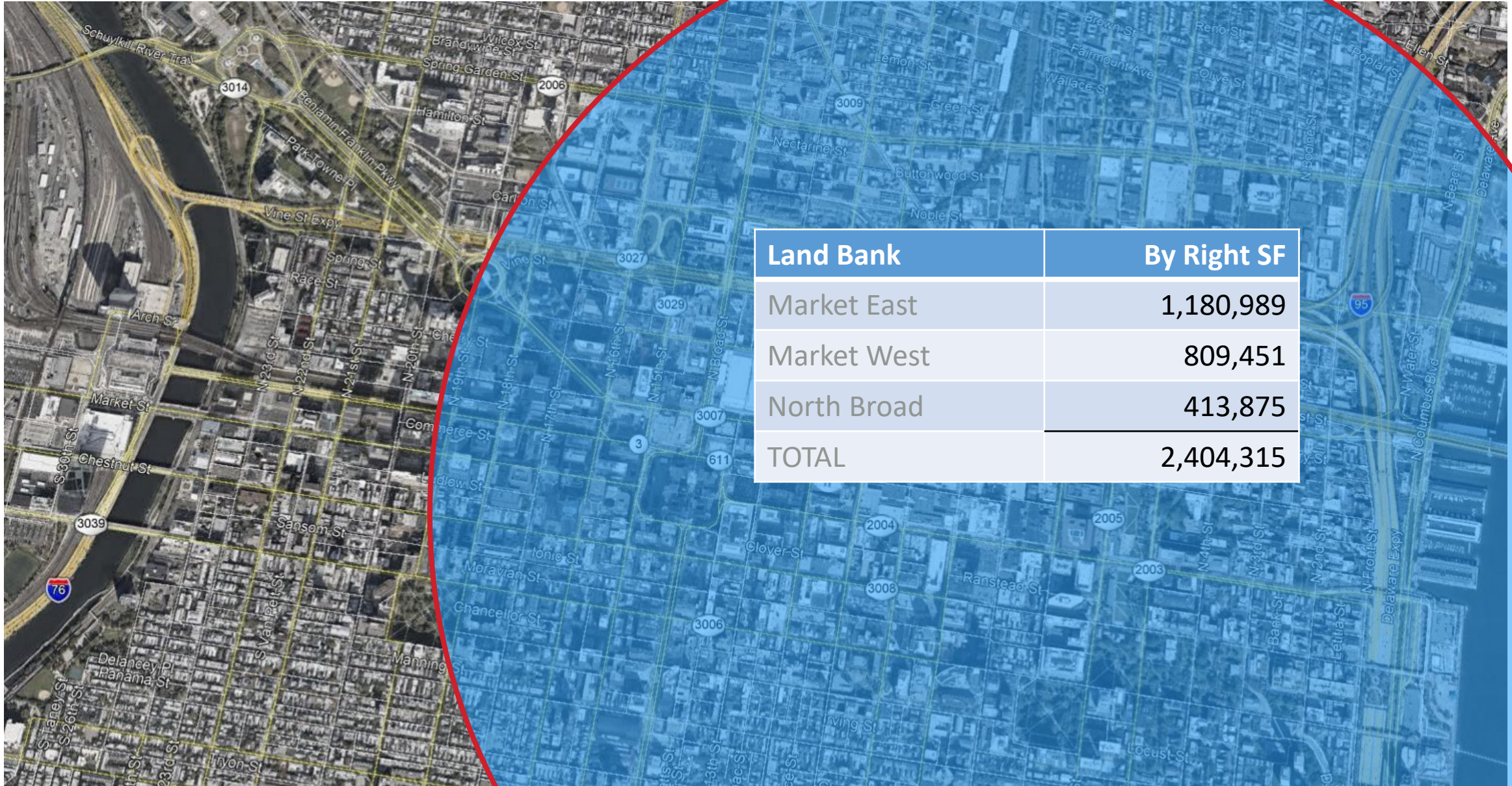

**Parkway Commercial Properties**  
**150 N. Broad Street**  
**Philadelphia, PA 19102**  
[www.parkwaycorp.com](http://www.parkwaycorp.com)







# MARKET EAST

## LAND BANK

- A. 709-13 Chestnut St**  
Zoning: CMX 5  
Area: 12,906 SF  
FAR 12: 154,872 SF
- B. 735 Arch St (Fed. Opp. Zone)**  
Zoning: ICMX  
Area: 39,550 SF  
FAR 5: 197,820 SF
- C. 19-27 S. 8<sup>th</sup> St**  
Zoning: CMX 5  
Area: 14,495 SF  
FAR 12: 174,204 SF
- D. 219 S. 13<sup>th</sup> St**  
Zoning: CMX 5  
Area: 9,020 SF  
FAR 12: 108,240 SF
- E. 804 Sansom St**  
Zoning: CMX 5  
Area: 23,471 SF  
FAR Available (through Unity of Use with Theater) = 545,853 SF

## REAL ESTATE

- 1. **Home2 Suites** - \$98M (sold)
- 2. **Penn Medicine** - \$84M
- 3. **Dow Building** - \$130M
- 4. **Pearl Condos** - \$34M (sold)
- 5. **2<sup>nd</sup> and Chestnut**

## OWNED STRUCTURED PARKING

- i. **12<sup>th</sup> and Walnut** – 616 spaces
- ii. **12<sup>th</sup> and Filbert** – 909 spaces
- iii. **Walnut Towers** – 686 spaces

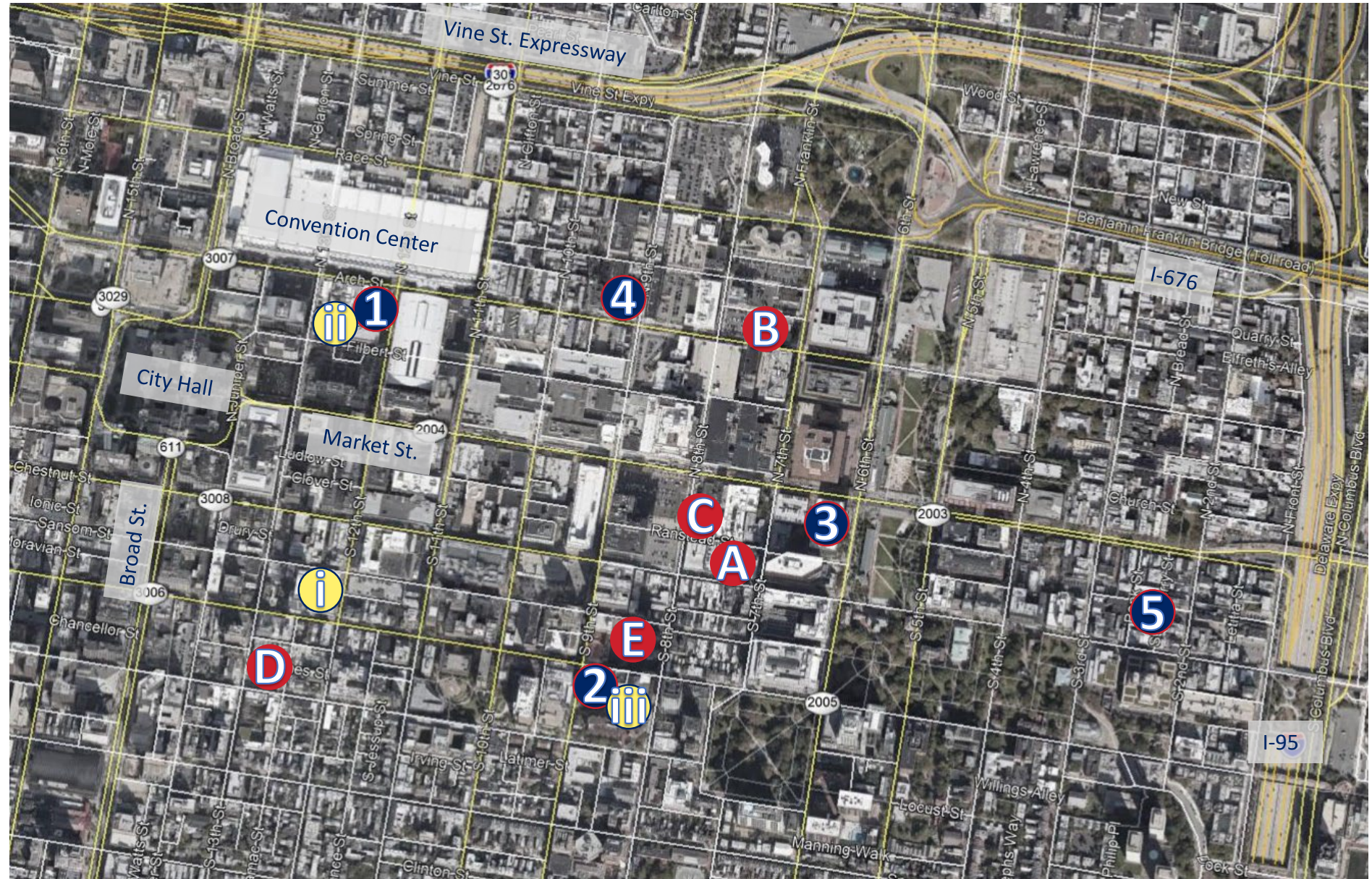



# Site Plan: 709-13 Chestnut St (711 Chestnut St)

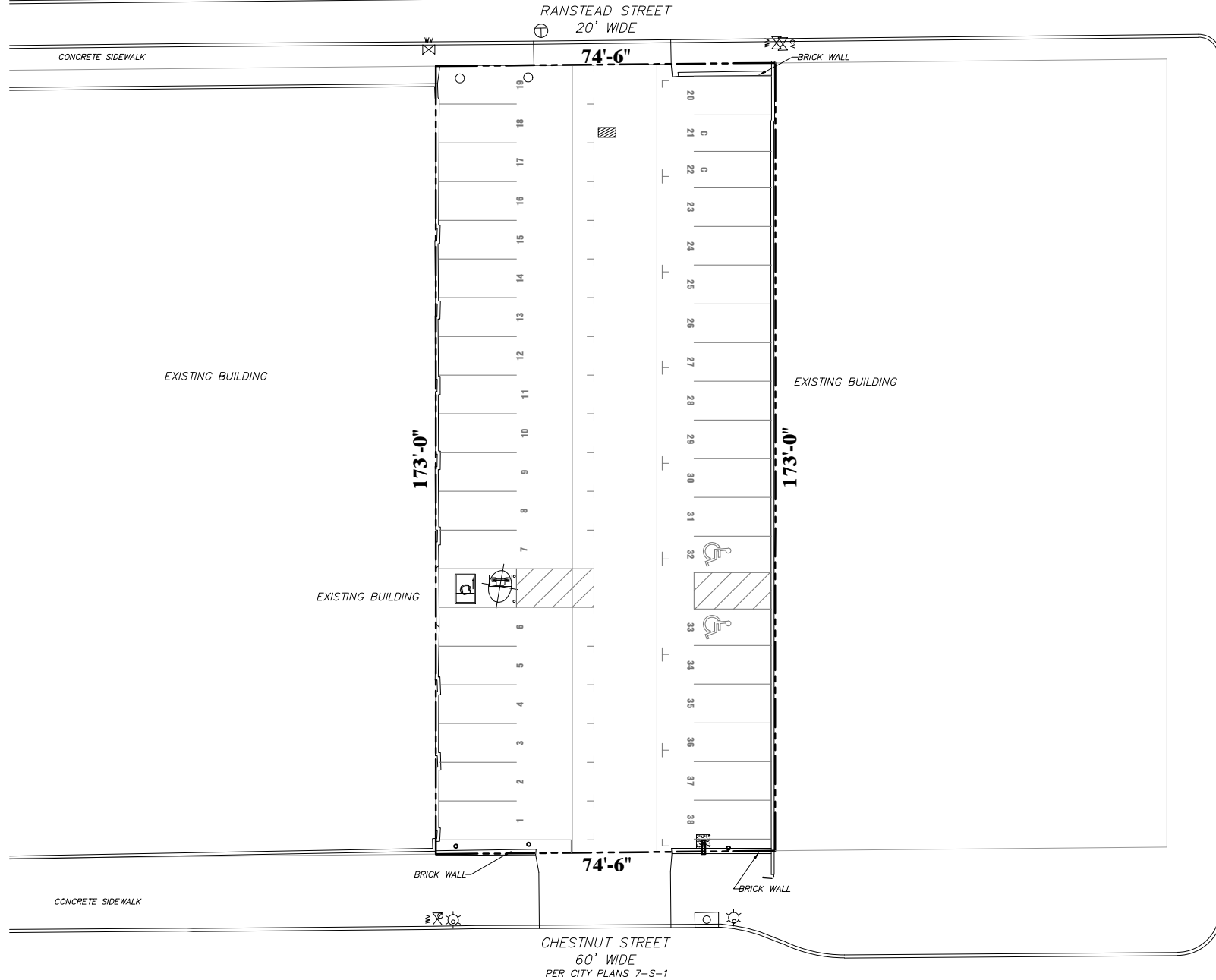

## 711 CHESTNUT SITE LAYOUT

SCALE: 1/32" = 1'-0"



This drawing is provided for illustrative purposes only and is not intended to be included in full or part of any set of construction documents, zoning applications, or any permits or license requests. All matter contained herein are the creation of Parkway Corporation. This document or any portion thereof may not be reproduced by any means without the prior written permission of Parkway Corporation.

SK 1

# Site Plan: 735 Arch St (8th & Arch)

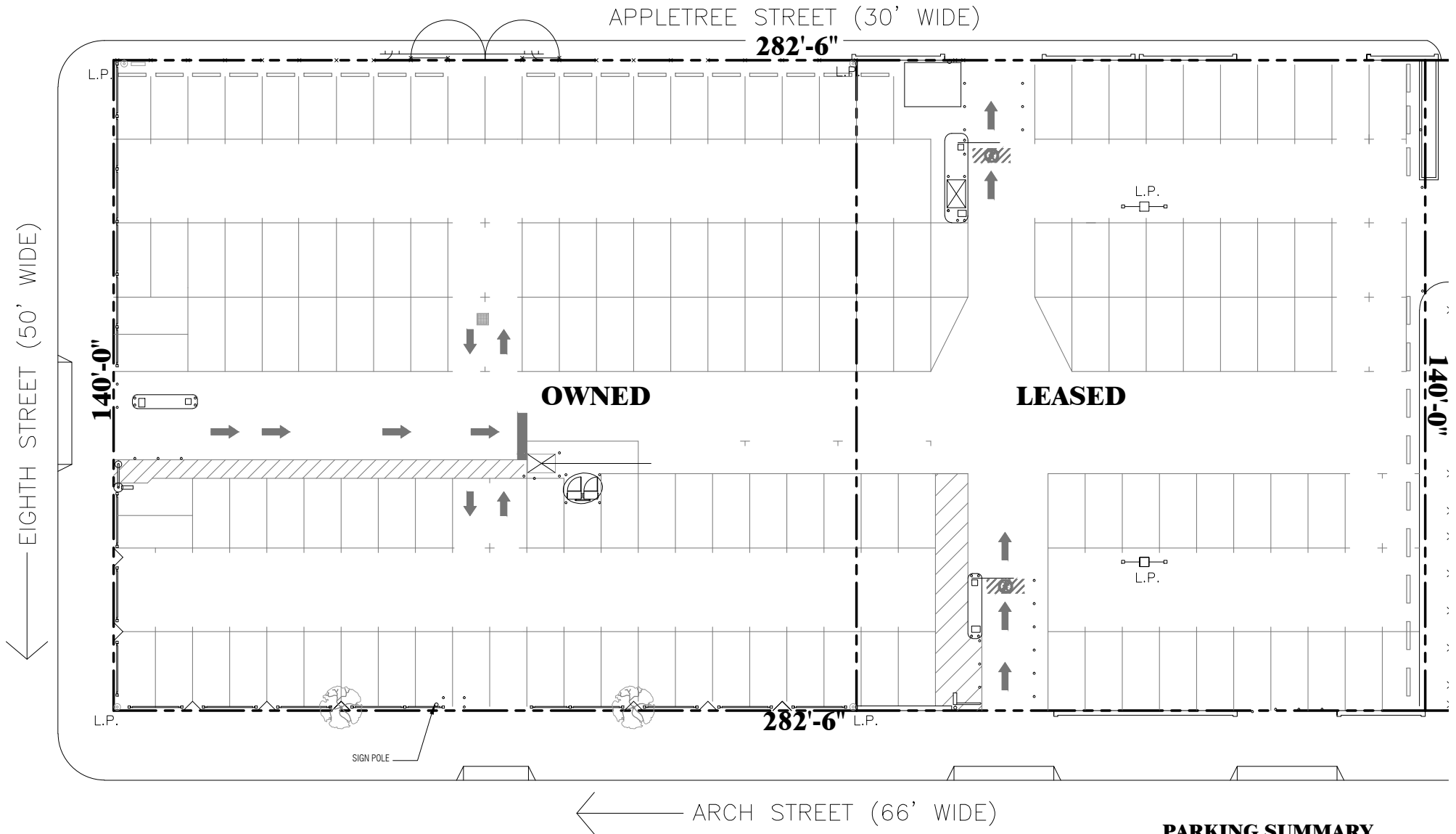

## PARKING SUMMARY

TOTAL LOT AREA:	39,550 S.F.
TOTAL CAPACITY:	225 SPACES



## 8TH & ARCH SURFACE PARKING LOT SITE LAYOUT

SCALE: 1" = 30'-0"



This drawing is provided for illustrative purposes only and is not intended to be included in full or part of any set of construction documents, zoning applications, or any permits or license requests. All matter contained herein are the creation of Parkway Corporation. This document or any portion thereof may not be reproduced by any means without the prior written permission of Parkway Corporation.

SK 1

# Site Plan: 19-27 S 8th St (8th & Ludlow)



## PARKING SUMMARY

TOTAL LOT AREA:	14,495 S.F.
TOTAL CAPACITY:	69 SPACES
SELF PARK SPACES:	31
ATTENDANT PARK SPACES:	38



## 8TH & LUDLOW STREETS PARKING LOT SITE LAYOUT

SCALE: 1" = 30'-0"



This drawing is provided for illustrative purposes only and is not intended to be included in full or part of any set of construction documents, zoning applications, or any permits or license requests. All matter contained herein are the creation of Parkway Corporation. This document or any portion thereof may not be reproduced by any means without the prior written permission of Parkway Corporation.

SK 1

# Site Plan: 219 S 13th St (13th & Locust)

ST. JAMES STREET

THIRTEENTH STREET

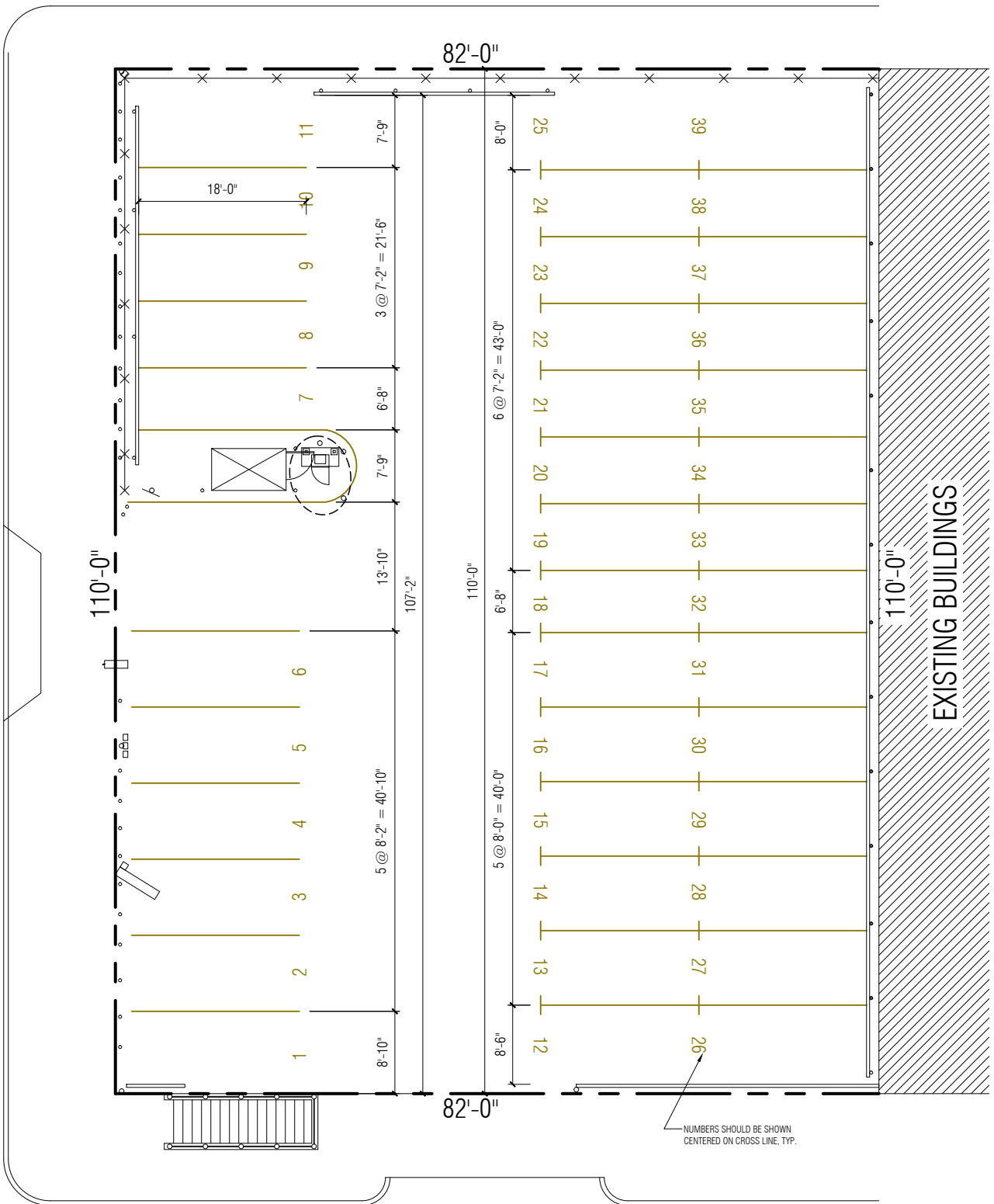

LOCUST STREET

## PARKING SUMMARY

TOTAL LEASED LOT AREA:	9020 S.F.
TOTAL CAPACITY:	39 SPACES
SELF PARK SPACES:	25
ATTENDANT PARK SPACES:	14



## 13TH & LOCUST STREET LOT EXISTING SITE PLAN -- 2-15-12

SCALE: 1/16" = 1'-0"

13LOCUST\_CURRENTPLAN\_021512/AEG



This drawing is provided for illustrative purposes only and is not intended to be included in full or part of any set of construction documents, zoning applications, or any permits or license requests. All matter contained herein are the creation of Parkway Corporation. This document or any portion thereof may not be reproduced by any means without the prior written permission of Parkway Corporation.

SK

1

**804 Sansom St (805 Walnut St)**

SANSOM STREET

100'-0"

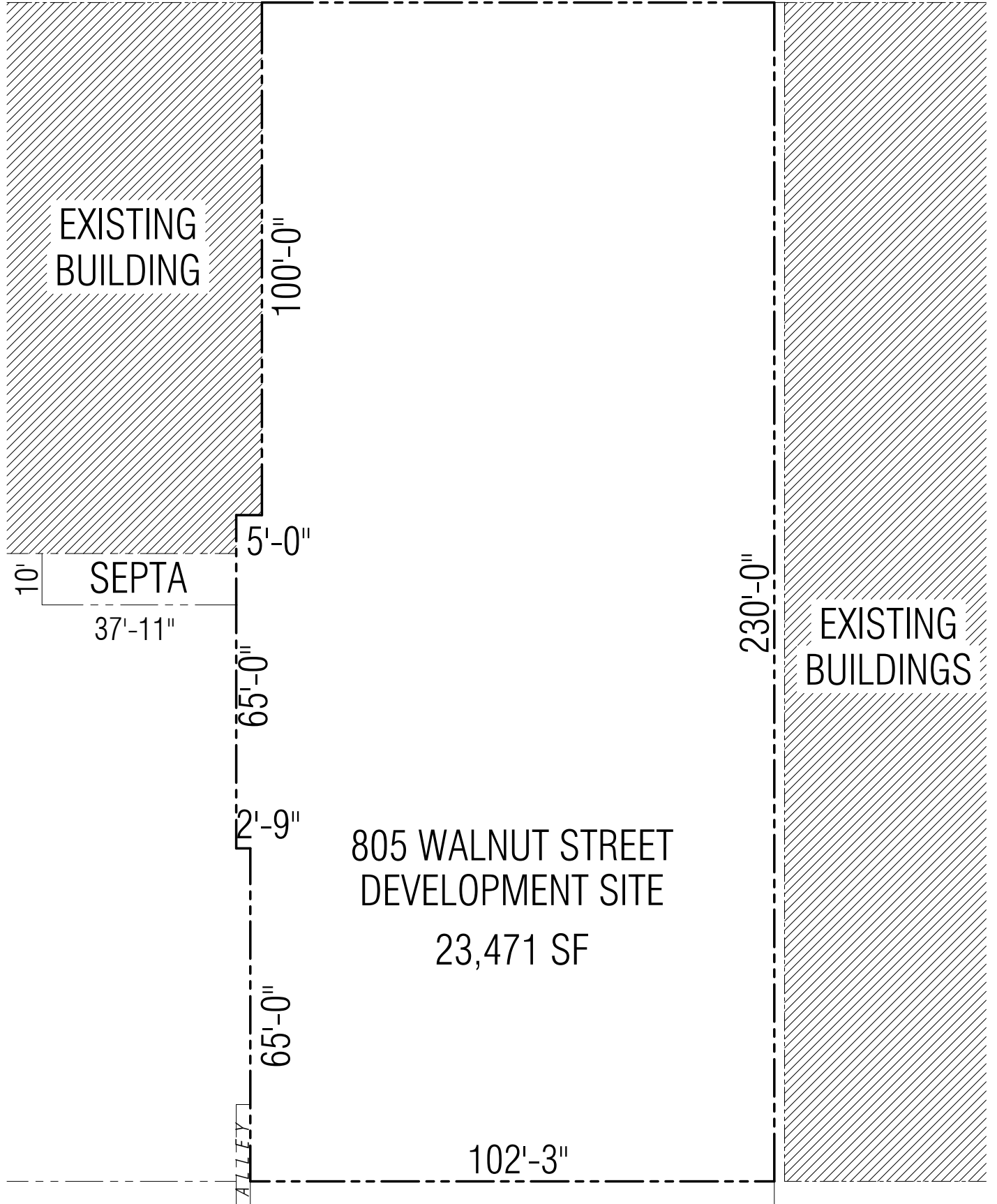

WALNUT STREET



# MARKET WEST

## LAND BANK

- A. **1443-49 Cherry St**  
Zoning: CMX 5  
Area: 53,568 SF  
FAR 12: 642,816 SF
- B. **1821 Chestnut St**  
Zoning: CMX 5  
Area: 3,000 SF  
FAR 12: 36,000 SF
- C. **26-30 S. 21<sup>st</sup> St**  
Zoning: CMX 4  
Area: 26,127 SF  
FAR 5: 130,635 SF

## REAL ESTATE

- 1. **Motto by Hilton Hotel** - \$67M
- 2. **1701 Market** - \$28M (sold)
- 3. **1706 Rittenhouse** - \$140M (sold)
- 4. **2222 Market** - \$220M
- 5. **2000 Arch** - \$409M

## OWNED STRUCTURED PARKING

- i. **Liberty Place** – 855 spaces
- ii. **150 North Broad** – 402 spaces

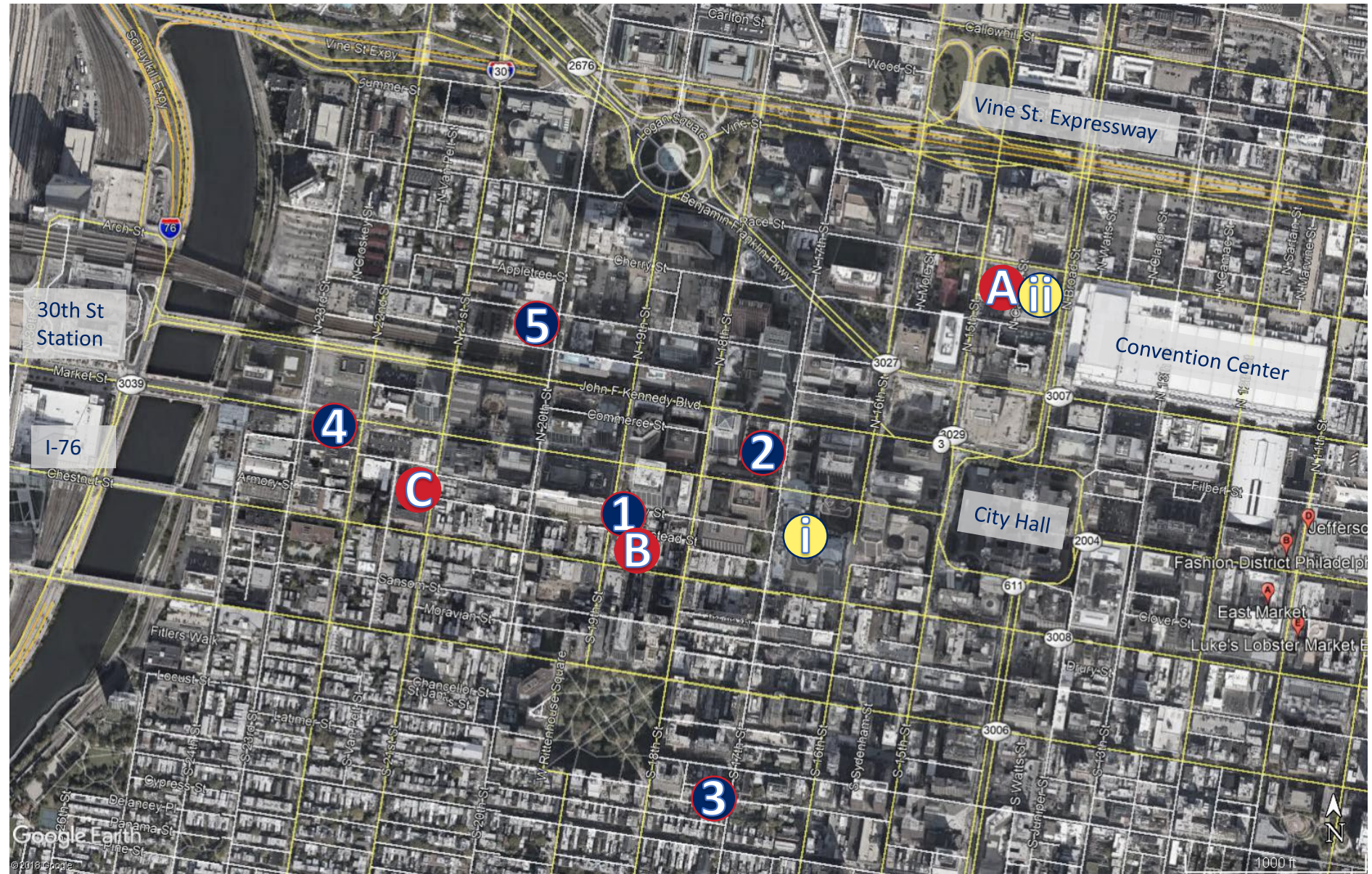



# Site Plan: 1443-49 Cherry St (15th & Cherry)

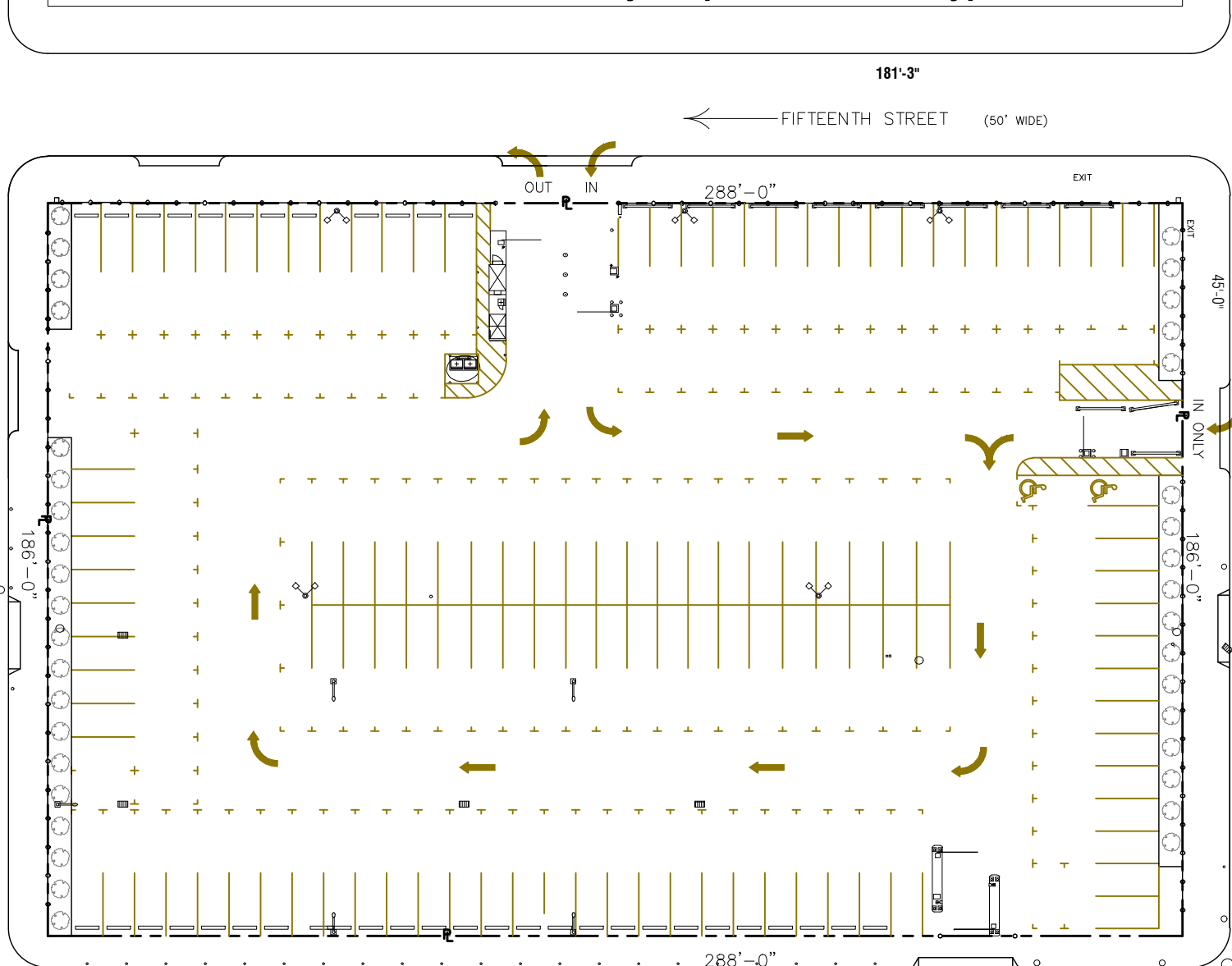

← CHERRY STREET (40' WIDE)

← FIFTEENTH STREET (50' WIDE)

RACE STREET (50' WIDE) →

← CARLISLE STREET (30' WIDE)

## PARKING SUMMARY

TOTAL LOT AREA:	53,568	S.F.
TOTAL CAPACITY:	277	SPACES
SELF PARK SPACES:	120	
ATTENDANT PARK SPACES:	157	



15TH & CHERRY STREET LOT  
**SITE PLAN -- 8-3-11**  
 SCALE: 1" = 40'-0"



This drawing is provided for illustrative purposes only and is not intended to be included in full or part of any set of plans, specifications, permits or license applications, all of which are contained herein on the creation of Parkway Corporation. This document, in any portion thereof, is void without the written permission of Parkway Corporation.





# Site Plan: 1821 Chestnut St

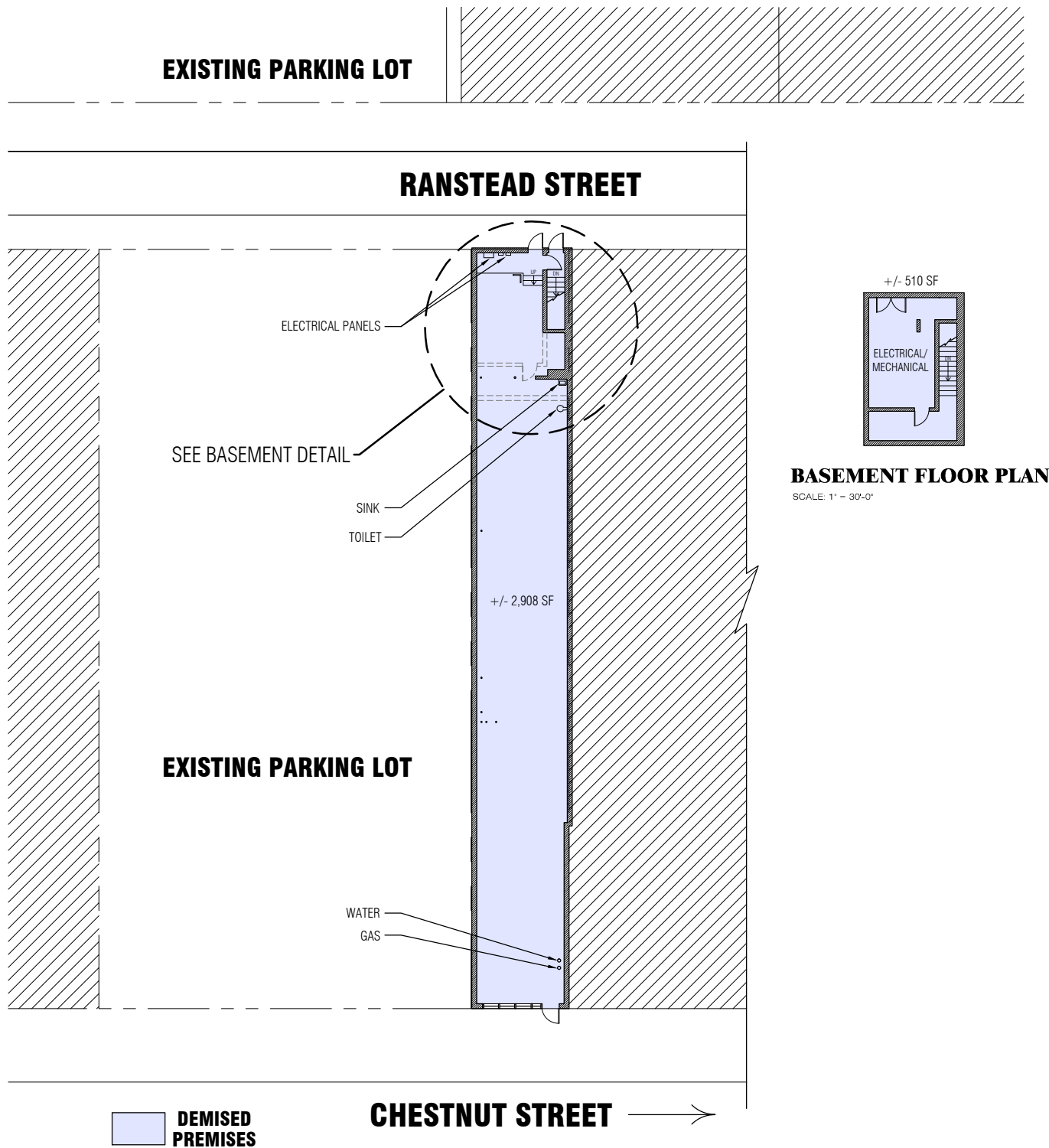

EXHIBIT "A"



## 1821 CHESTNUT STREET GROUND FLOOR/SITE PLAN

SCALE: 1" = 30'-0"

ISSUED: 2-27-14



This drawing is provided for illustrative purposes only and is not intended to be included in full or part of any set of construction documents, zoning applications, or any permits or license requests. All matter contained herein are the creation of Parkway Corporation. This document or any portion thereof may not be reproduced by any means without the prior written permission of Parkway Corporation.



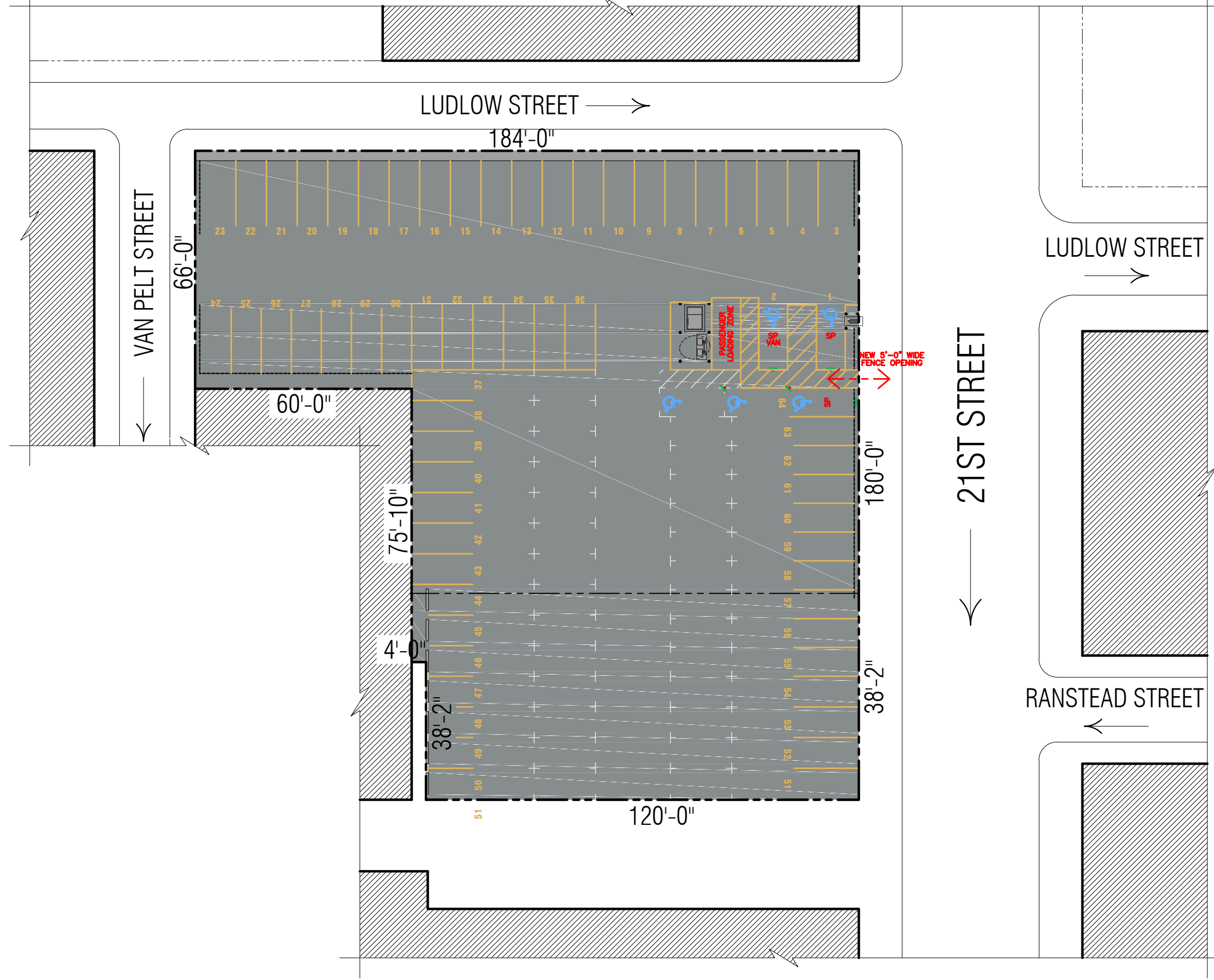

SK

1

# Site Plan: 26-30 S 21st St (21st & Ludlow)



### LEGEND

-  : PROPOSED 4" WIDE YELLOW SELF-PARK LINE STRIPING
-  : PROPOSED 2" WIDE WHITE ATTENDANT-PARK LINE STRIPING
-  : PROPOSED SELF PARK A.D.A. SPACE
-  : PROPOSED A.D.A. SIGNAGE



**PROPOSED A.D.A. IMPROVEMENTS**  
**SITE PLAN**  
 SCALE: 1"= 30'-0"



PARKWAY CORPORATION  
 REAL ESTATE & DEVELOPMENT  
 150 NORTH BROAD STREET  
 PHILADELPHIA, PA 19102  
 (215) 575-4080

**21ST AND LUDLOW STREET**  
**ATTENDANT PARK SURFACE LOT**  
**FUNCTIONAL DESIGN**

DATE: 7-31-17  
 DESCRIPTION: LAYOUT CONCEPT

SK

1



# NORTH BROAD

## LAND BANK (All Fed Opp Zones)

- A. **1122 Vine St – 12<sup>th</sup> & Race St**  
Zoning: CMX 4  
Area: 52,738 SF  
FAR 5: 263,690 SF
- B. **1329 Race St**  
Zoning: CMX 4  
Area: 1,504 SF  
FAR 5: 7,500 SF
- C. **1217-41 Callowhill**  
Zoning: I 2  
Area: 28,706 SF  
FAR 5: 142,685 SF

## REAL ESTATE

- 1. **Hanover N Broad** - \$150M

## OWNED STRUCTURED PARKING

- i. **Hanover West** – 256 spaces

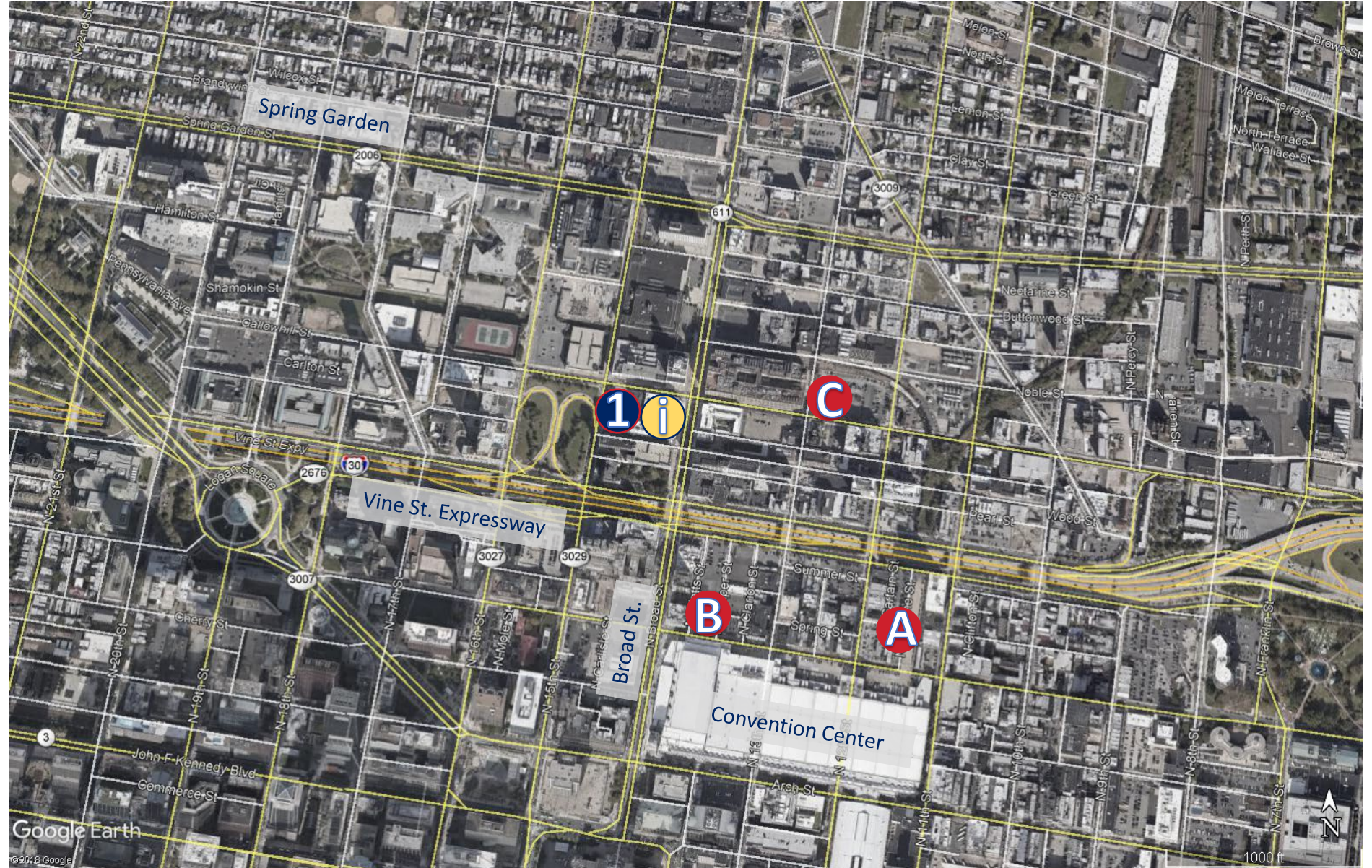



# Site Plan: 1122 Vine St - 12th & Race St (1127 Race St)

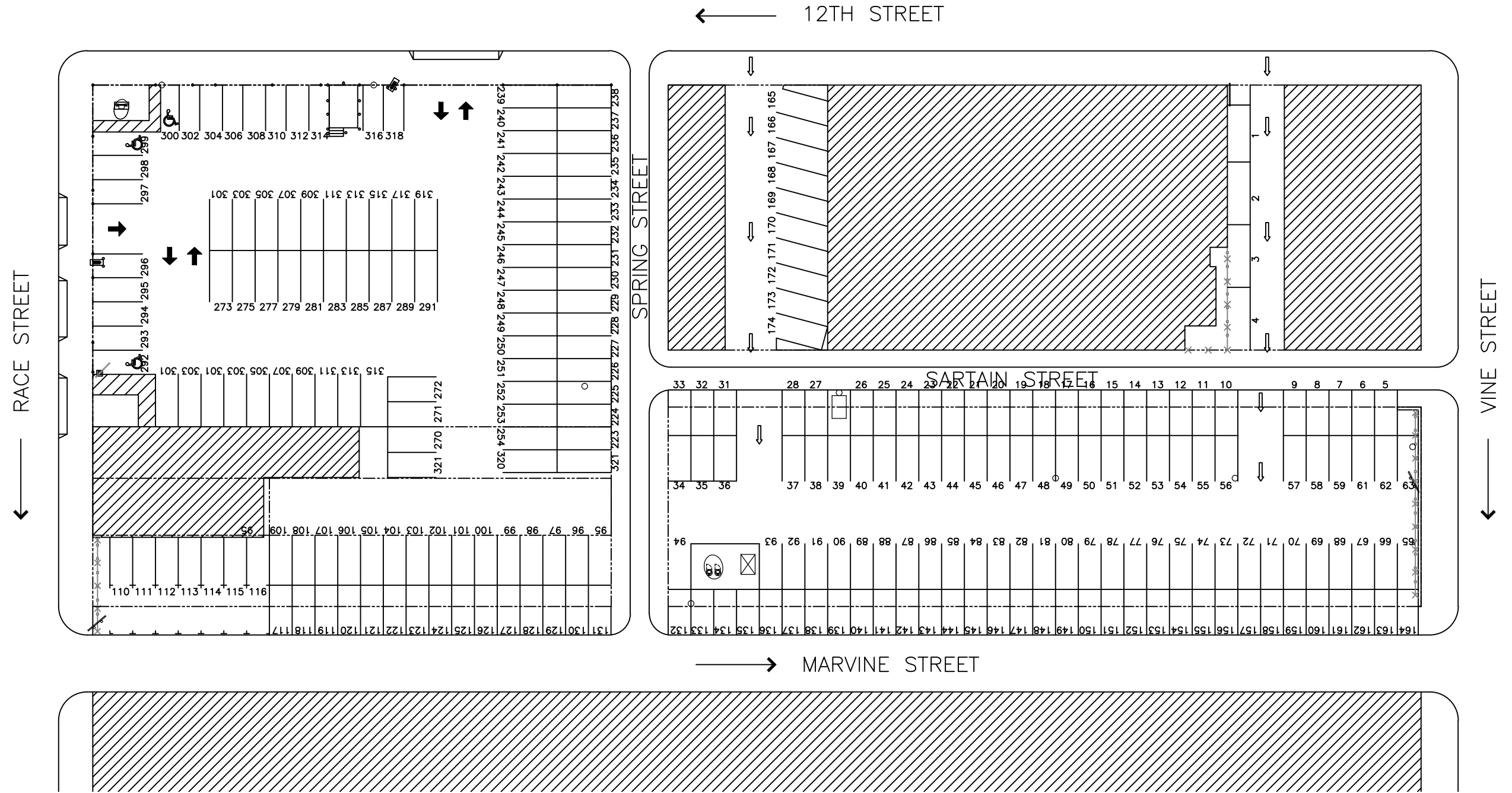

## PARKING SUMMARY

TOTAL LOT AREA:	62,840 S.F.
TOTAL CAPACITY:	259 SPACES
SELF PARK SPACES:	252
ATTENDANT PARK SPACES:	7



## CURRENT LAYOUT SITE PLAN

SCALE: 1" = 40'-0"



DATE: 04-10-2015  
DESCRIPTION: SCHEMATIC DESIGN

1127 RACE STREET  
SURFACE PARKING LOT  
FUNCTIONAL DESIGN

PARKWAY CORPORATION  
REAL ESTATE & DEVELOPMENT  
150 NORTH BROAD STREET  
PHILADELPHIA, PA 19102  
(215) 575-4080

This drawing is provided for illustrative purposes only and is not intended to be included in full or part of an set of construction documents, zoning applications or any permits or license requests. All matter contained herein are the creation of Parkway Corporation and this document shall not be used for any other purpose without the prior written permission of Parkway Corporation.

SK

1



# Federal Opportunity Zone

# 1122 Vine St – 12<sup>th</sup> and Race St

Zoning: CMX 4 (by right)  
Lot 52,738 SF  
FAR 5 = 263,690 SF  
FAR 12 = 632,856 SF

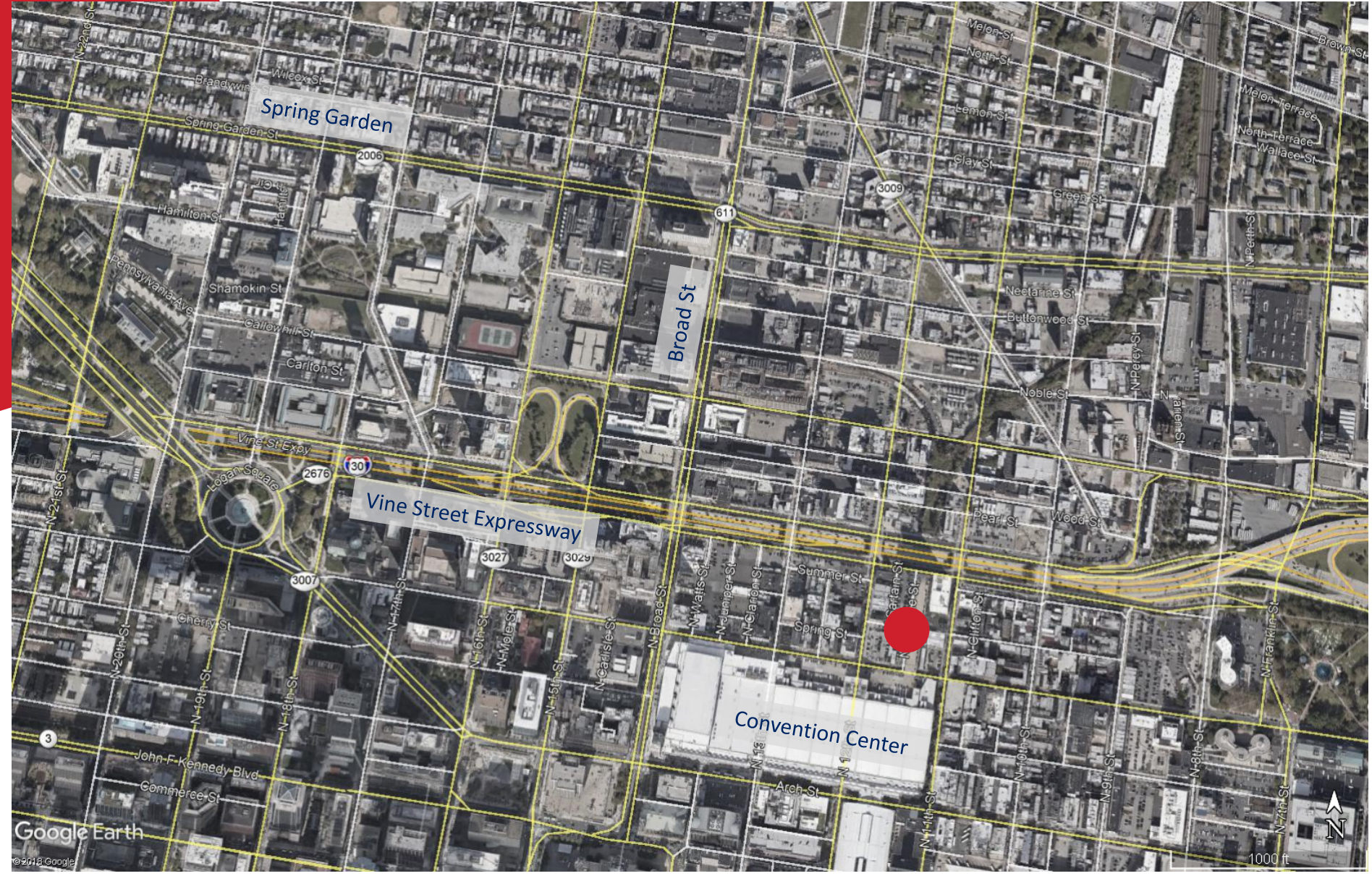



# 1122 Vine St – 12<sup>th</sup> and Race St

Zoning: CMX 4 (by right)

Lot 52,738 SF

FAR 5 = 263,690 SF

FAR 12 = 632,856 SF

Site Plan

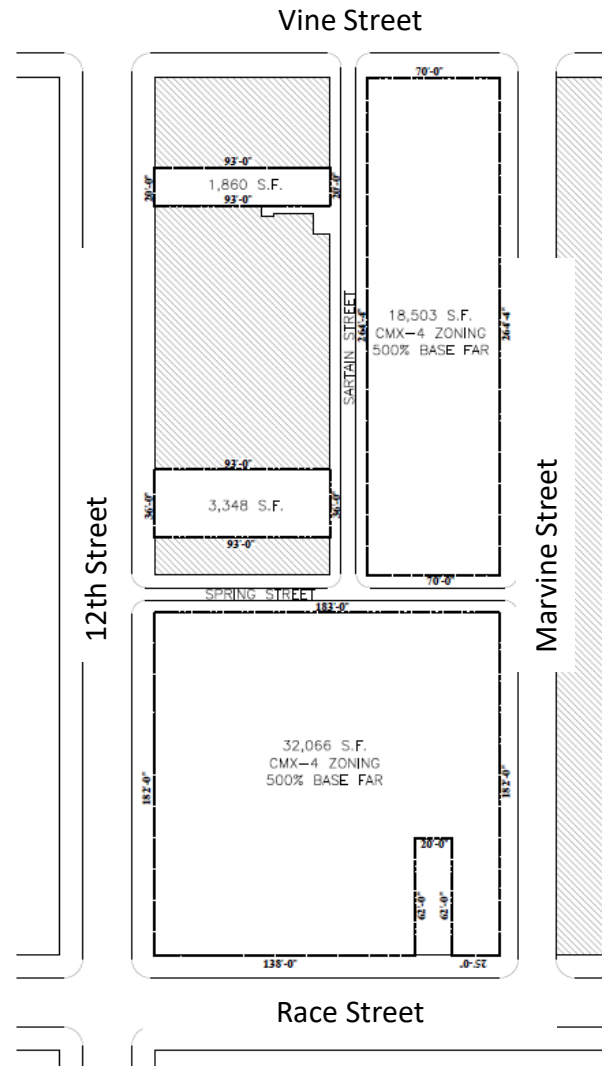

Existing Plan

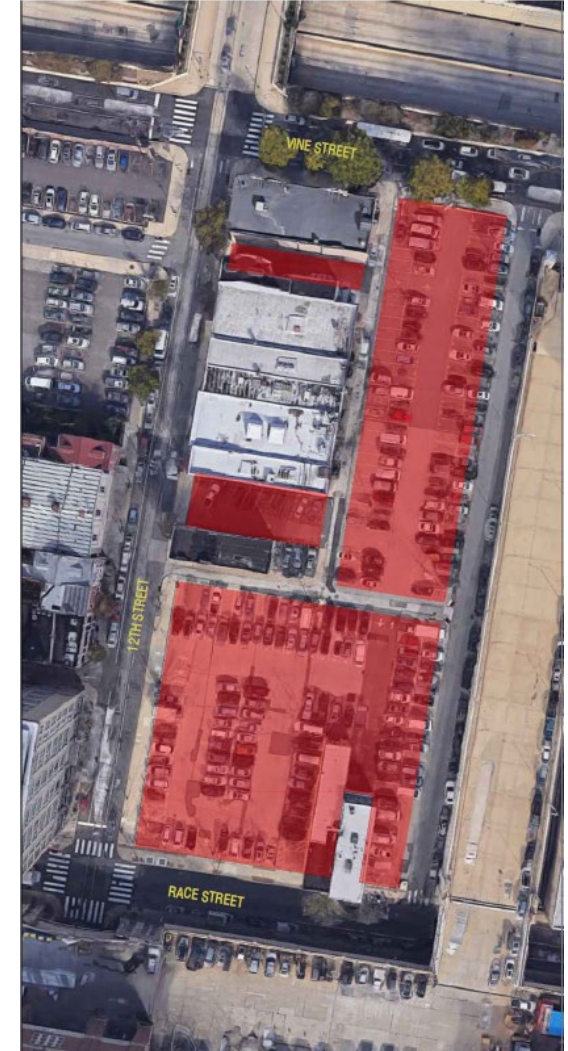



# 1122 Vine St – 12<sup>th</sup> and Race St

Zoning: CMX 4 (by right)

Lot 52,738 SF

FAR 5 = 263,690 SF

FAR 12 = 632,856 SF

Aerial Photo



# Site Plan: 1329 Race St

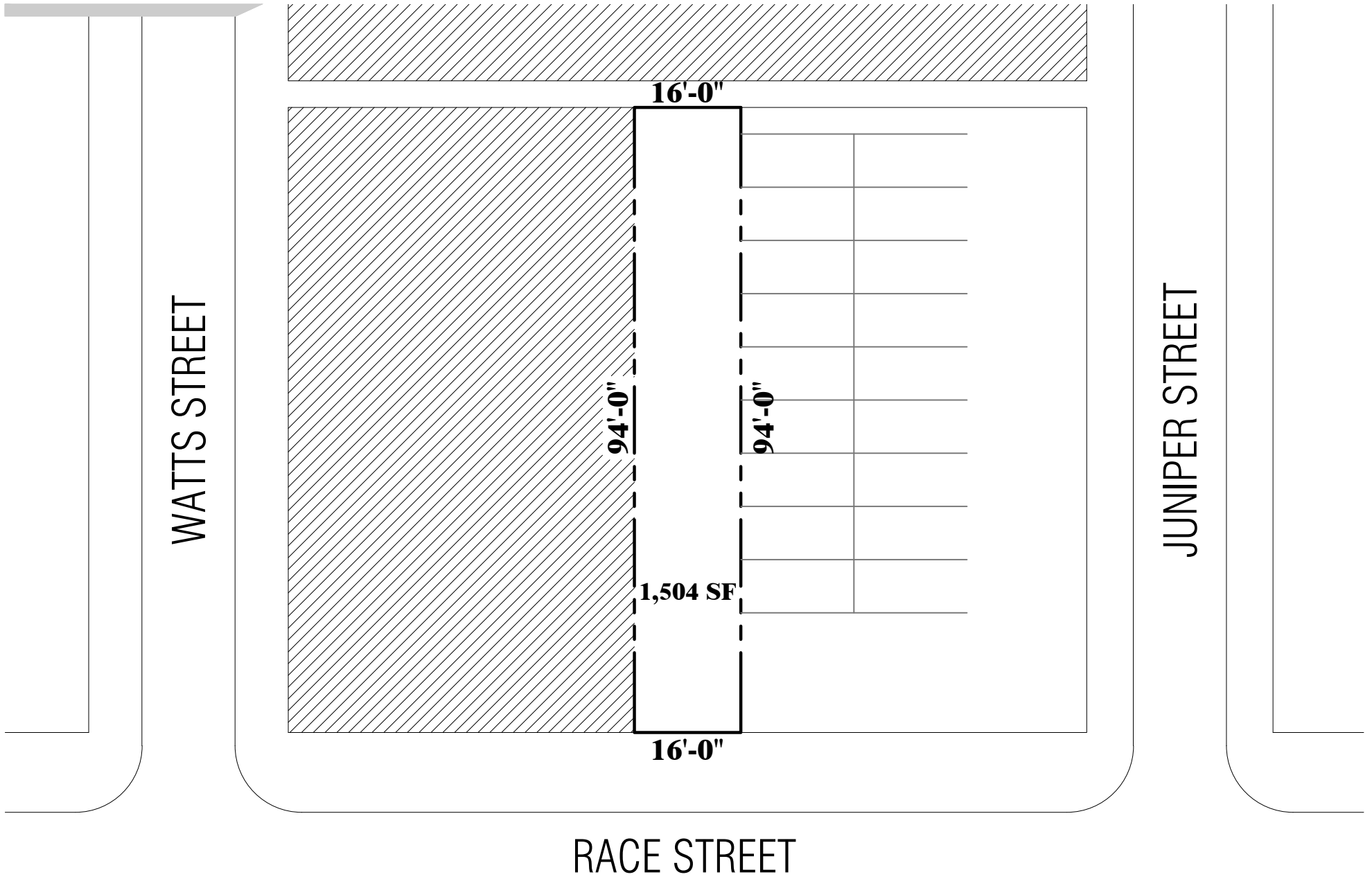

## 1329 RACE STREET SITE LAYOUT

SCALE: 1" = 20'-0"



This drawing is provided for illustrative purposes only and is not intended to be included in full or part of any set of construction documents, zoning applications, or any permits or license requests. All matter contained herein are the creation of Parkway Corporation. This document or any portion thereof may not be reproduced by any means without the prior written permission of Parkway Corporation.

SK

1

# Site Plan: 1217-41 Callowhill (13th & Callowhill)

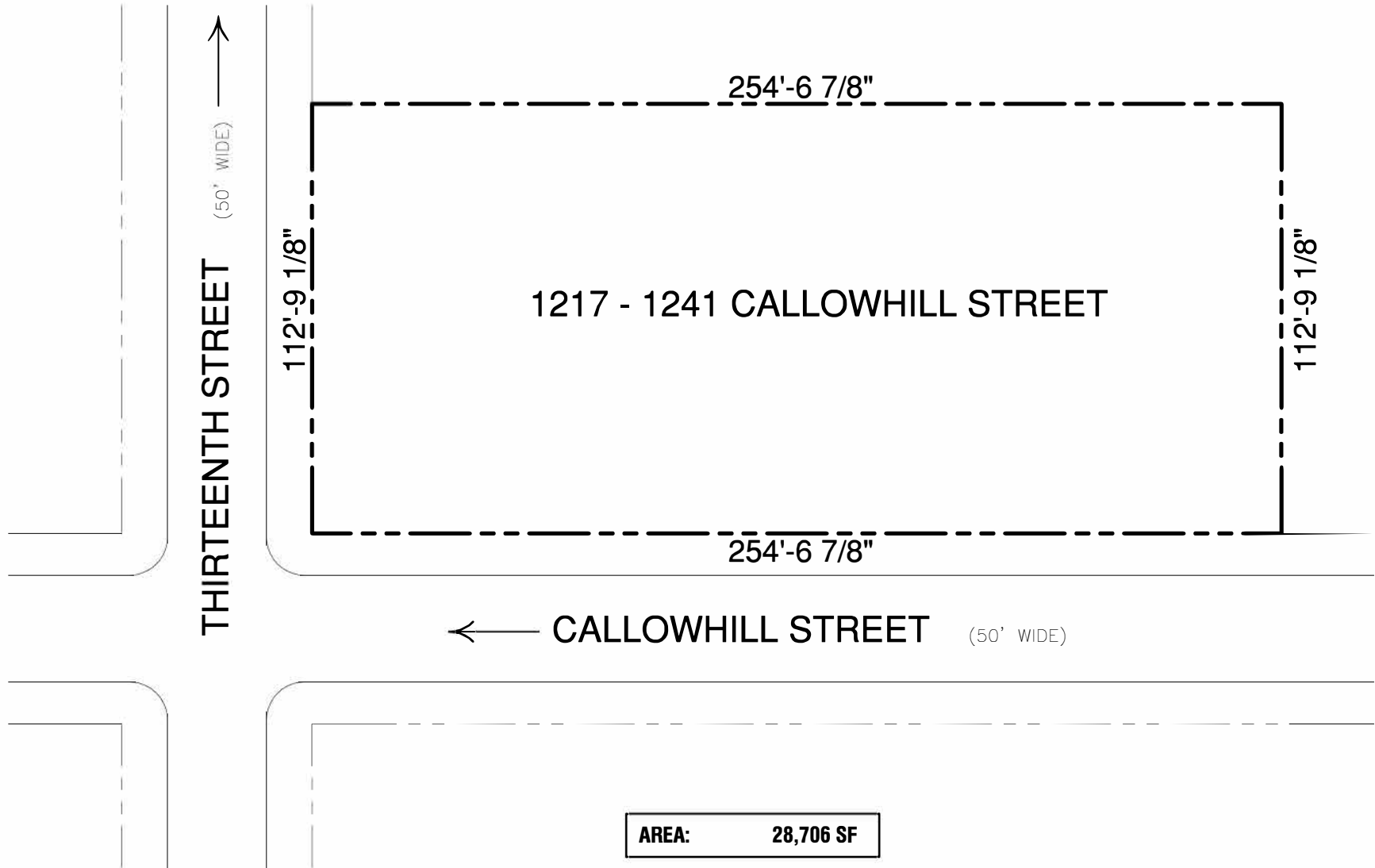

## 13TH & CALLOWHILL STREETS SURFACE PARKING LOT EXISTING CONDITIONS / SITE PLAN -- 7-24-07

SCALE: 1" = 40'-0"

13CALPARKET



This drawing is provided for illustrative purposes only and is not intended to be included in full or part of any set of construction documents, zoning applications, or any permits or license requests. All matter contained herein are the creation of Parkey Corporation. This document or any portion thereof may not be reproduced by any means without the prior written permission of Parkey Corporation.

SK

1







# 1217-41 Callowhill

Zoning: I2 (by right)

Lot 28,706 SF

FAR 5 = 142,685 SF

Zoning: CMX 4 (re-zoned)

FAR 5 = 142,685 SF

FAR 12 = 342,444 SF

## Site Plan





# 1217-41 Callowhill

## Site Plan

Zoning: I2 (by right)

Lot 28,706 SF

FAR 5 = 142,685 SF

Zoning: CMX 4 (re-zoned)

FAR 5 = 142,685 SF

FAR 12 = 342,444 SF

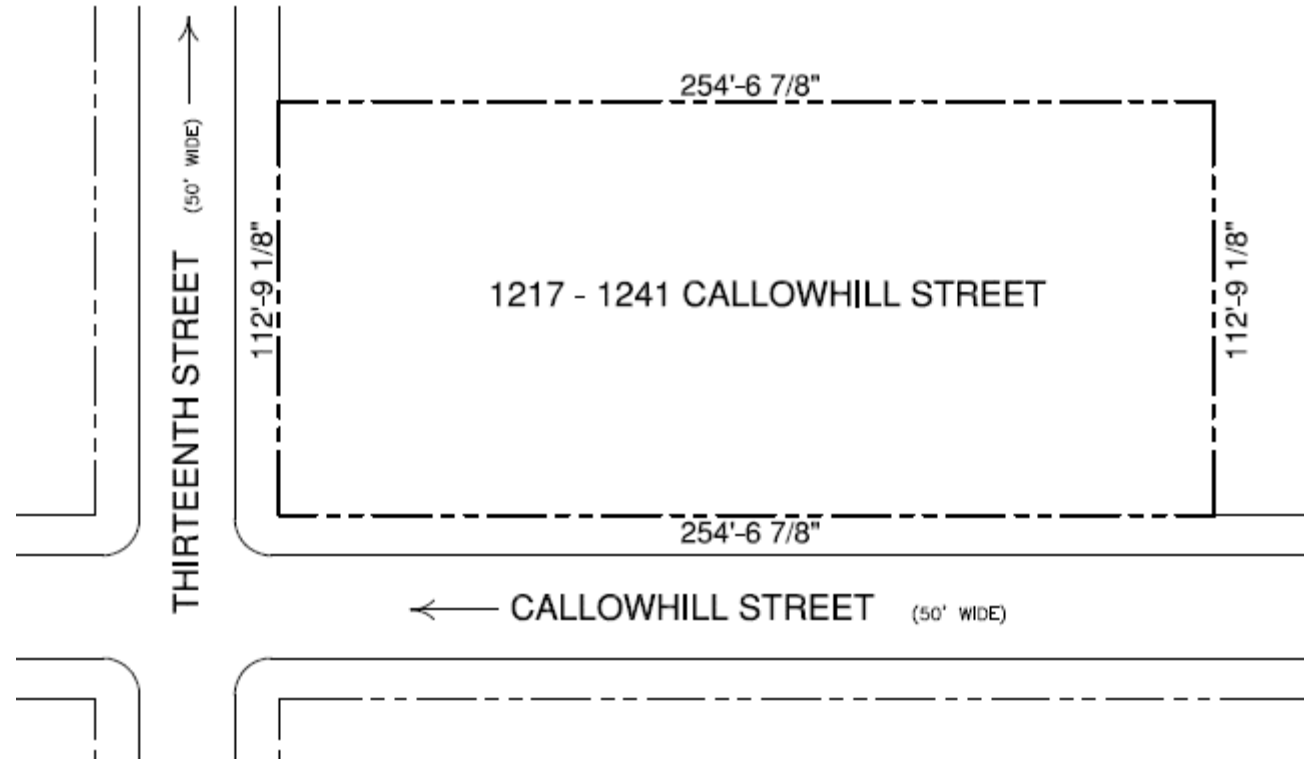

# 1217-41 Callowhill

Zoning: I2 (by right)

Lot 28,706 SF

FAR 5 = 142,685 SF

Zoning: CMX 4 (re-zoned)

FAR 5 = 142,685 SF

FAR 12 = 342,444 SF

Aerial Photo

